

Συμβιωτικά περιβάλλοντα κατοίκησης: Υβριδικά συστήματα
συνεργασίας μεταξύ τεχνολογίας, φύσης και σωμάτων

τρίτη_23_απριλίου_2024

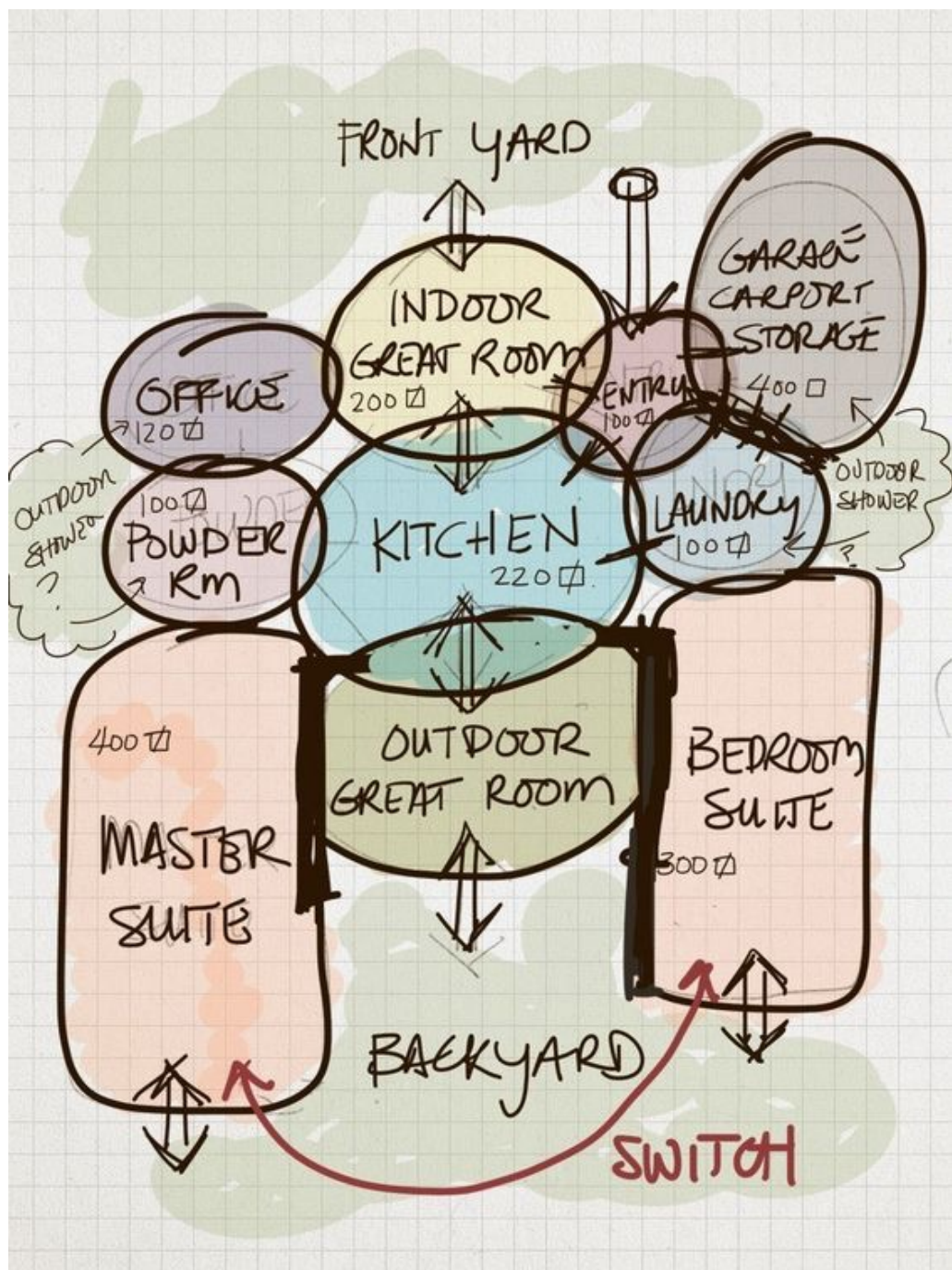

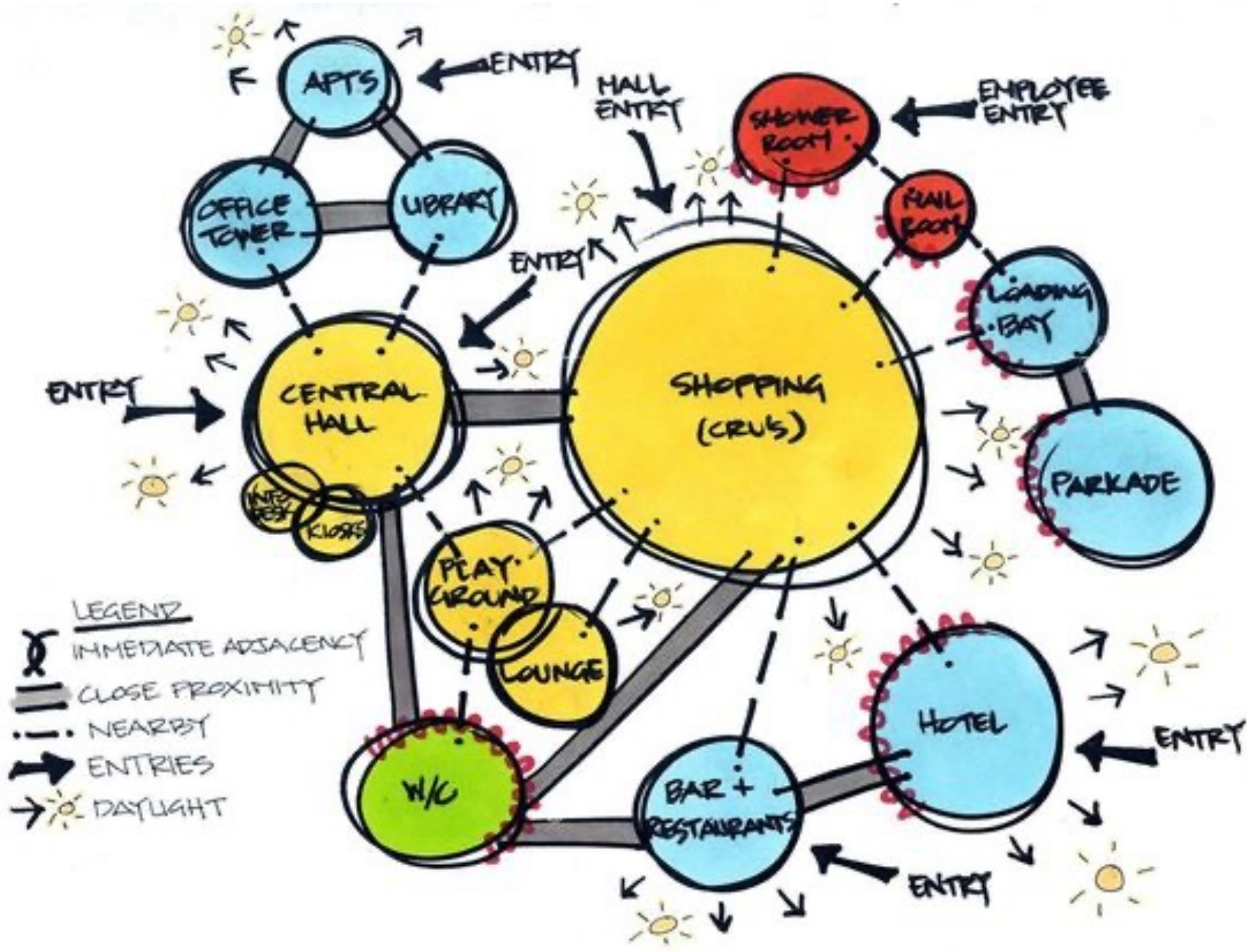

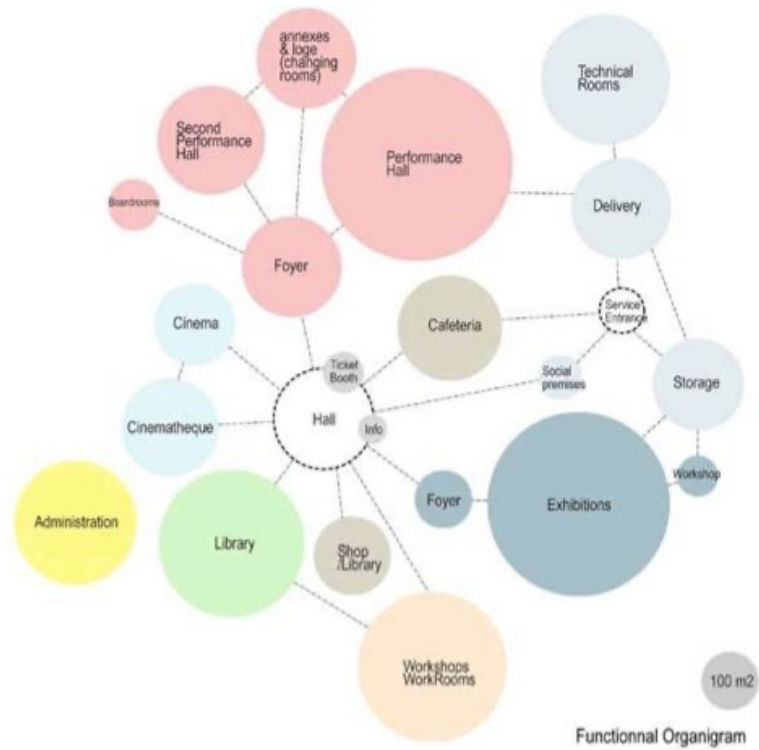

ΒΑΣΙΚΗ ΘΕΣΗ ΤΥΠΩΝ ΣΤΗΝ ΚΤΗΡΙΑΚΗ ΔΟΜΗ

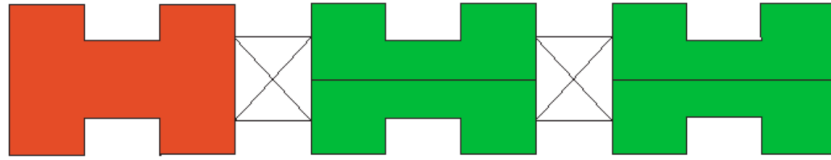
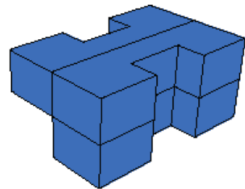
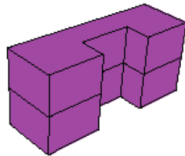
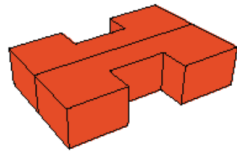
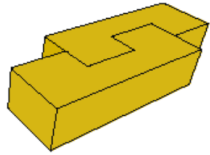
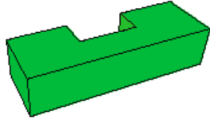

ΚΑΤΩΦΗ Α' ΟΡΟΦΟΥ
ΚΛΙΜΑΚΑ 1:200

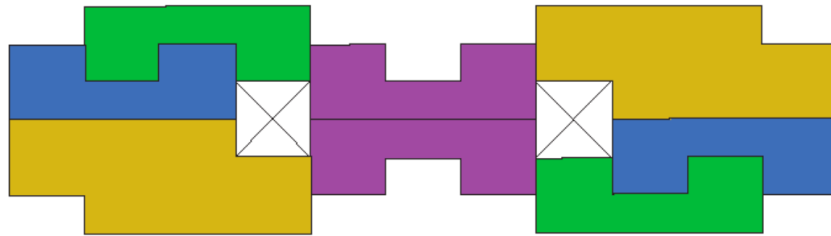

ΚΑΤΩΦΗ Β' ΟΡΟΦΟΥ
ΚΛΙΜΑΚΑ 1:200

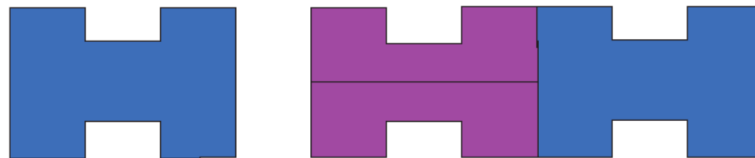

ΚΑΤΩΦΗ Γ' ΟΡΟΦΟΥ
ΚΛΙΜΑΚΑ 1:200

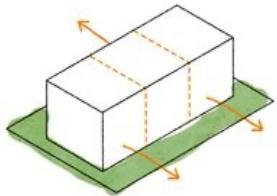
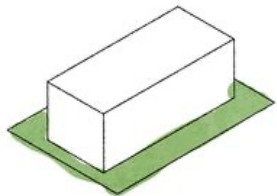
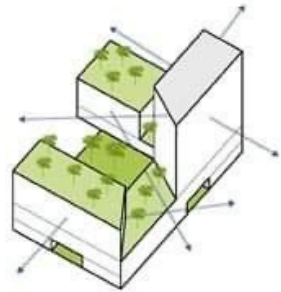
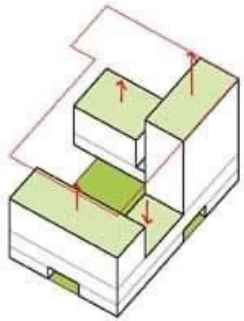
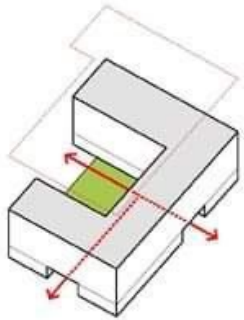
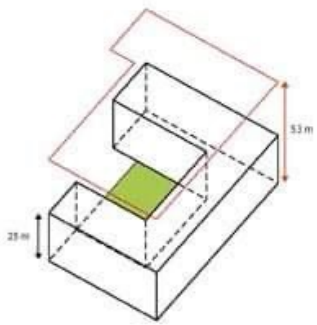

1

2

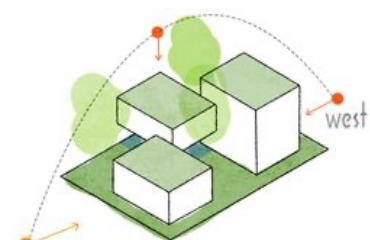
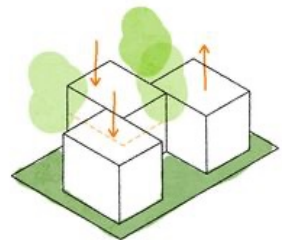

3

4

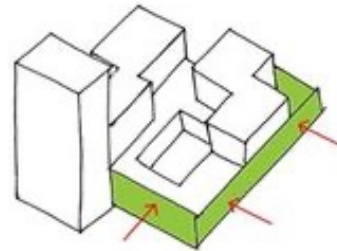
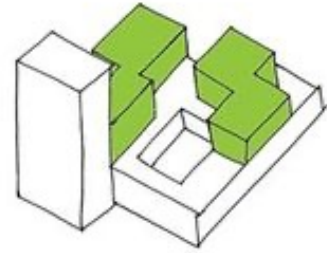
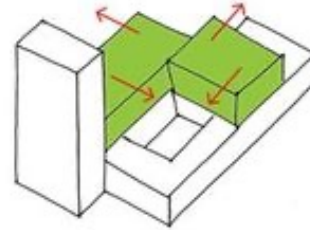
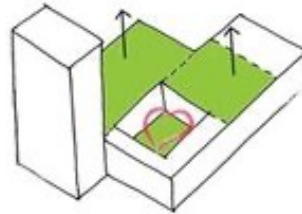
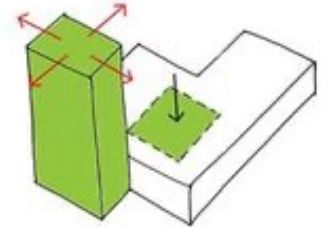
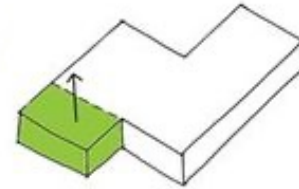
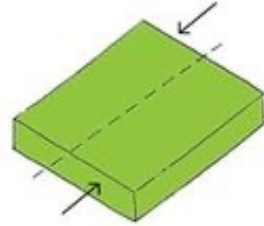

MASSING STRATEGY

Ut tunc ut porro totum, ut magnam quod in nonneque sed ornam dicitur, officina non exequia et per et perferente curant, tunc rerum quo que et filium la nobis ipse rem. Ut tunc ut porro totum, ut magnam quod in nonneque sed ornam dicitur, officina non exequia et per et perferente curant, tunc rerum quo que et filium la nobis ipse rem. Ut tunc ut porro totum, ut magnam quod in nonneque sed ornam dicitur, officina non exequia et per et perferente curant, tunc rerum quo que et filium la nobis ipse rem.



Ut tunc ut porro totum, ut magnam quod in nonneque sed ornam dicitur, officina non exequia et per et perferente curant, tunc rerum quo que et filium la nobis ipse rem.

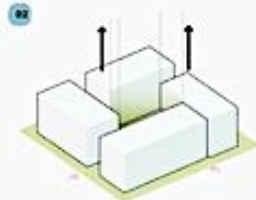

Ut tunc ut porro totum, ut magnam quod in nonneque sed ornam dicitur, officina non exequia et per et perferente curant, tunc rerum quo que et filium la nobis ipse rem.

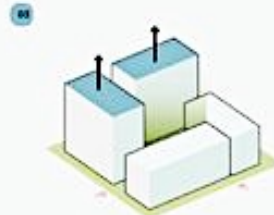

Ut tunc ut porro totum, ut magnam quod in nonneque sed ornam dicitur, officina non exequia et per et perferente curant, tunc rerum quo que et filium la nobis ipse rem.



Ut tunc ut porro totum, ut magnam quod in nonneque sed ornam dicitur, officina non exequia et per et perferente curant, tunc rerum quo que et filium la nobis ipse rem.



Ut tunc ut porro totum, ut magnam quod in nonneque sed ornam dicitur, officina non exequia et per et perferente curant, tunc rerum quo que et filium la nobis ipse rem.



Ut tunc ut porro totum, ut magnam quod in nonneque sed ornam dicitur, officina non exequia et per et perferente curant, tunc rerum quo que et filium la nobis ipse rem.

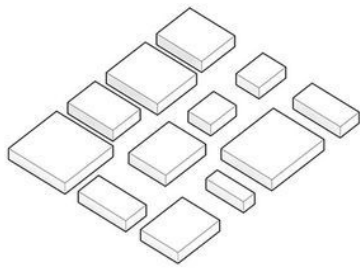

PROGRAM REQUIREMENTS

The precinct requires twelve separate program types.

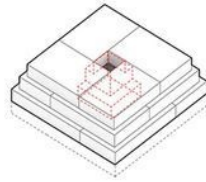

MASSING & PROGRAM ORGANIZATION

Programs are organized vertically to retain all required adjacencies and visual connections in a compact volume. Each program is represented by an individual volume, which is then stacked around a central atrium as an organizing principal.

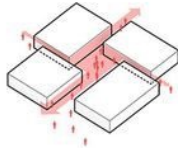

PRECINCTS WITHIN A PRECINCT

Volumes are grouped according to the relationship between each program. Separation of volumes accommodates circulation while defining each box as a separate entity within the structure. Internally, this provides individual spaces for the precinct's groups, forming an urban plan at the scale of a building. Setbacks emphasize entrances and create clearances between the precinct and adjacent buildings.

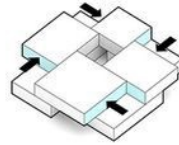

SETBACKS & WINDOWS

This system of separation and setbacks is repeated on the upper floors. The setbacks push the volumes inward to create space for windows that are removed from the street, increasing privacy and security. They also accommodate mandatory mechanical and zoning requirements.

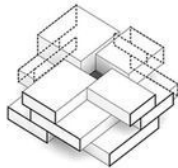

BRICKS

From the outside, the program volumes resemble a stack of boxes, unified through material expression. They can also be read as bricks, referencing the nuscated bases of early NYC precinct station houses. Rather than evoke the notion of fortification, the bricks of the 40th Precinct Station reference the various police and community functions that the building serves.

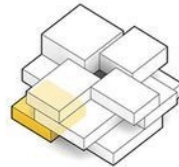

COMMUNITY

A separately accessible community room will be the first of its kind in the city. At the street-facing façade, small circular perforations in the concrete panels call attention to the special function of this particular programmatic block, allowing for transparency that is essential to the NYPD's plans for this new kind of public space.

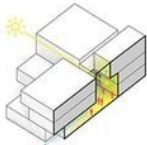

ATRIUM

All program areas, entrances and circulation routes are oriented towards the central atrium. This allows for complete oversight from the main desk while maintaining visual relationships between all floors. Clerestory windows at the upper level bring daylight into the building's core.

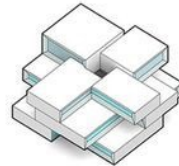

PERIMETER FAÇADES • SETBACK FAÇADES

All perimeter walls are kept solid in sandblasted, pre-cast concrete panels, while setback façades are composed of polished concrete and reflective materials to contrast the solid perimeter walls. Angled panels surrounding the windows are tapered to continue the notion of "pushing in". Where mechanical equipment must be set back from property lines, glass is replaced with perforated metal to conceal equipment while allowing for airflow.

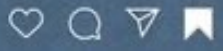

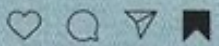
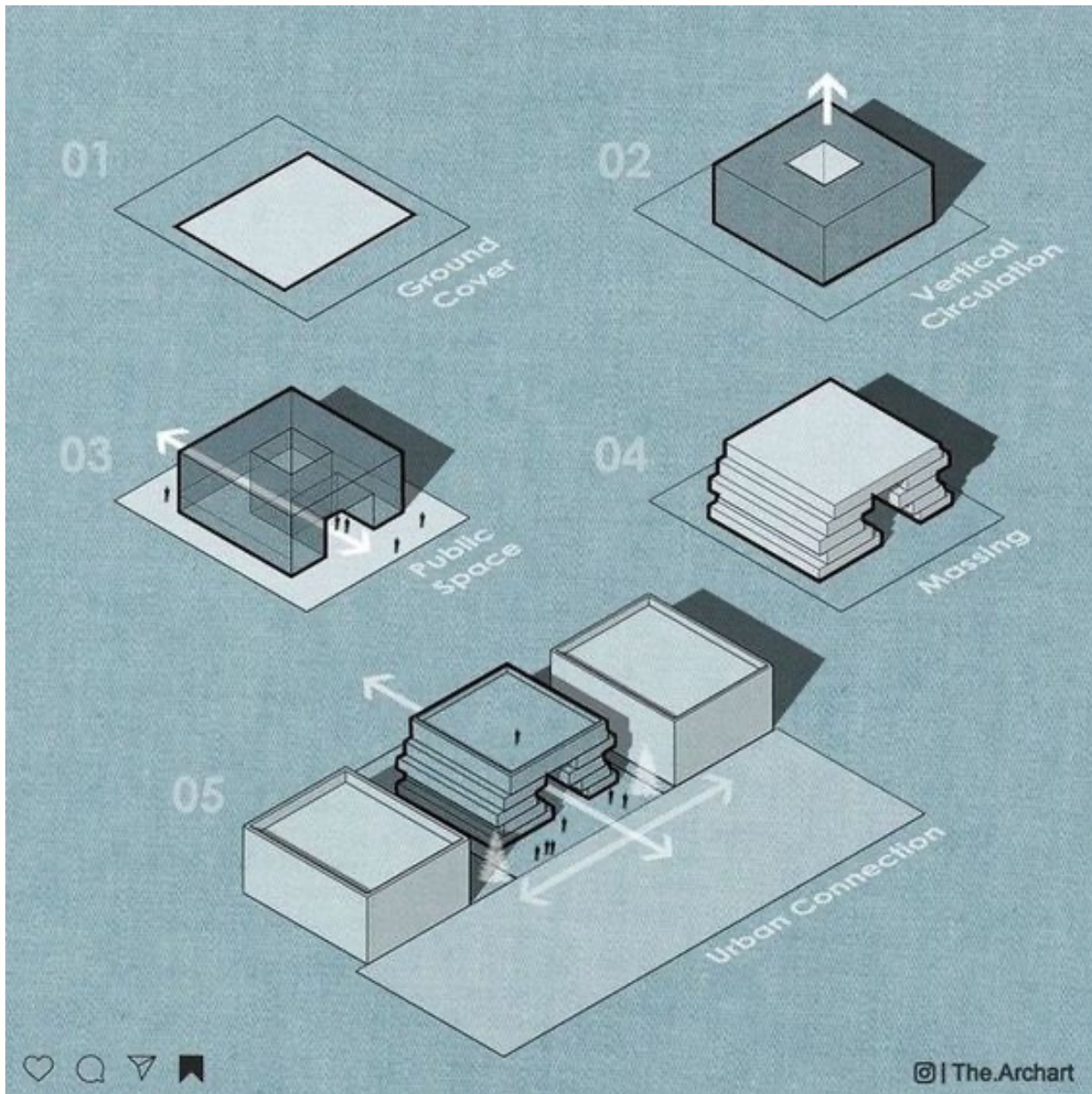

01

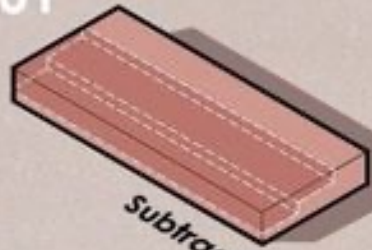

Subtract

02

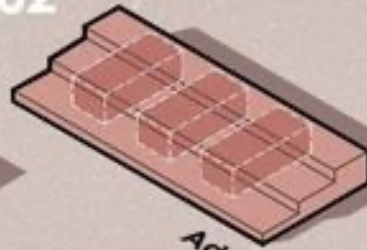

Add

03

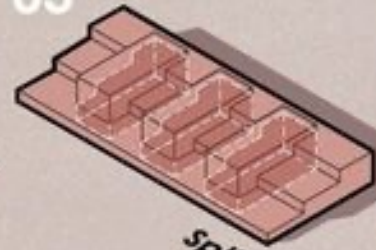

Split

04

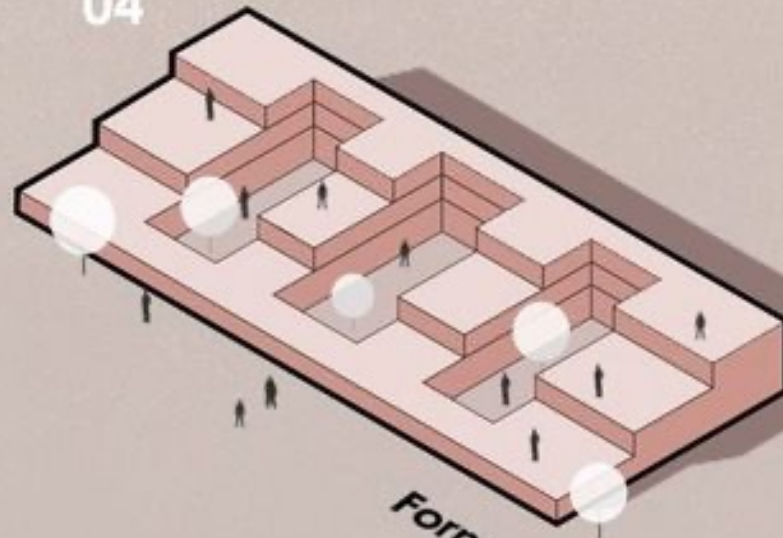

Form

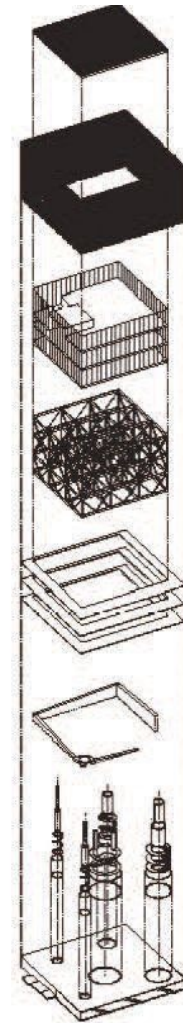
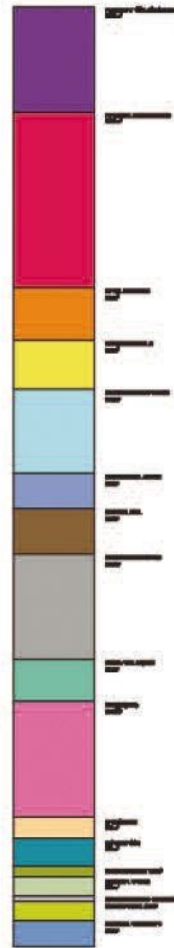
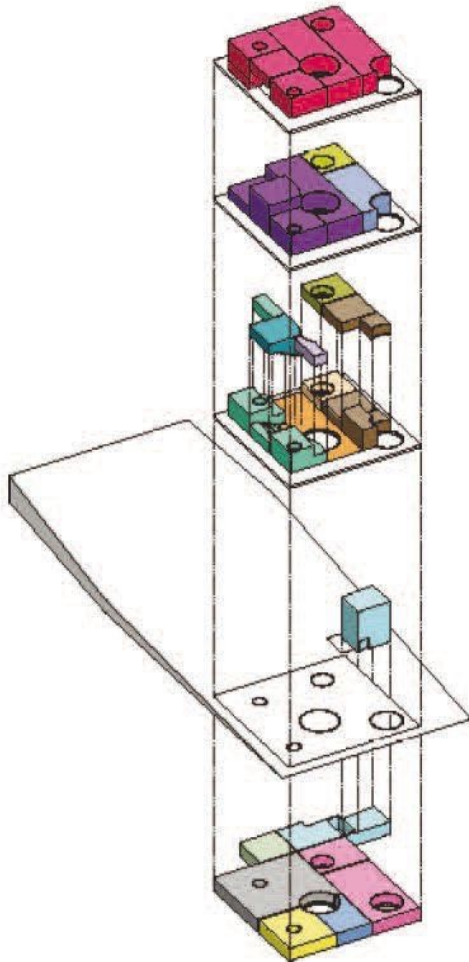

SOLAR PANELS
- 1420 m²

TUBULAR FACADE
- water thermal coating
- solar water heating
- steel spool production
- sun shading

GLASS FACADE
low E triple glazing

STEEL FRAME STRUCTURE
- super-structural box

OUTDOOR TERRACES
- 4000 m²

EXHIBITION RAMP
- 2% ramp
- permit to ramp, wheelchair

VERTICAL CONNECTIONS
- central elevators
- concrete structural columns
- hydraulic escalator
- integrated structural glass

MAIN PLAZA
- building programmatic base
- vehicle access

STAIRS TO RIVER
- scaffolding stairs

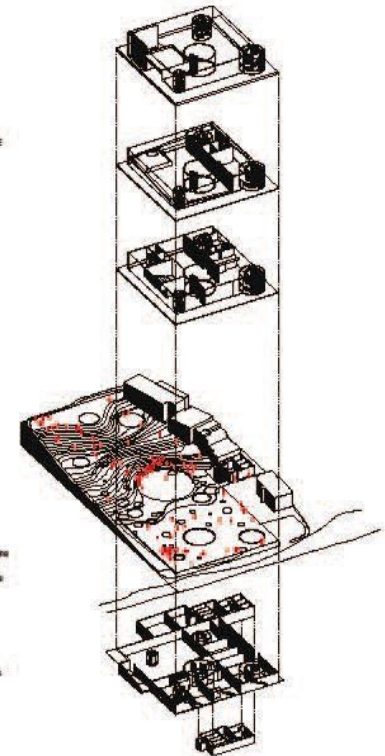

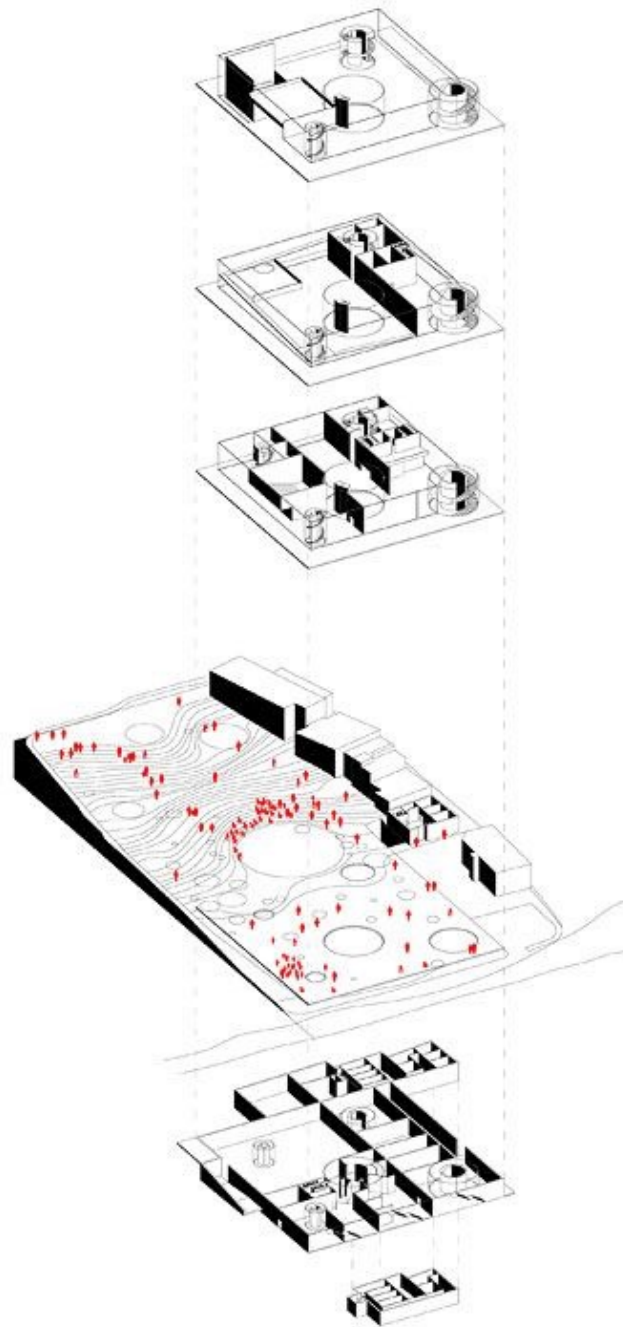
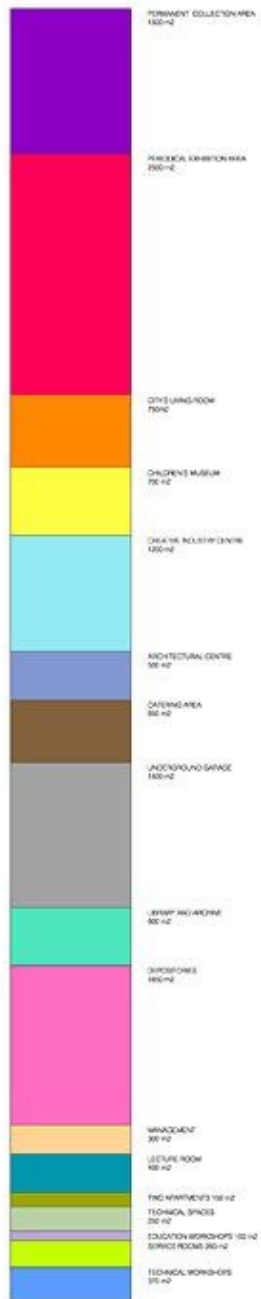
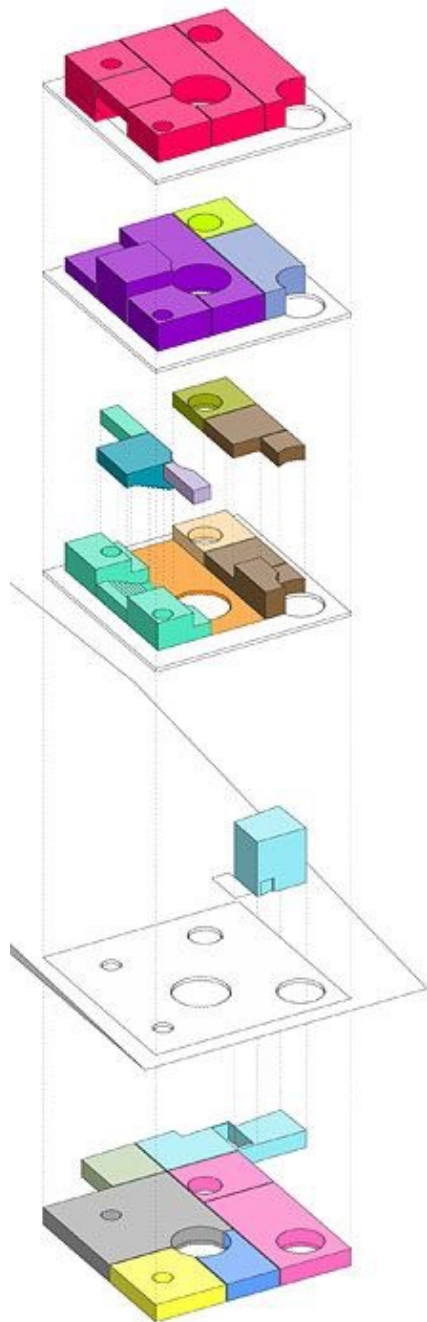

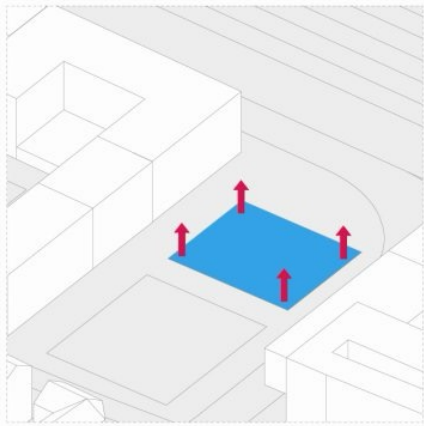

EXTRUDE

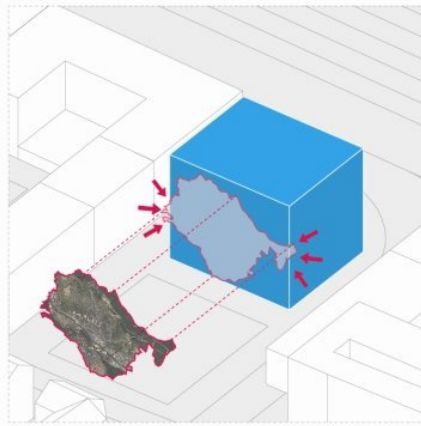

PROJECT MAP

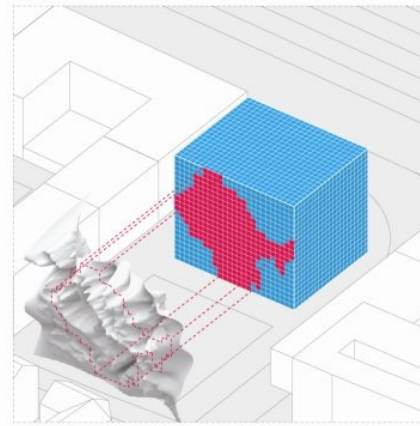

PROJECT LANDSCAPE

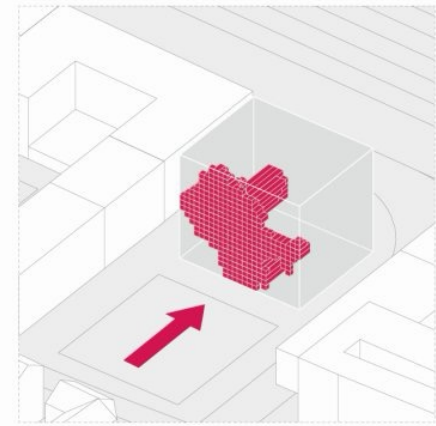

PUSH

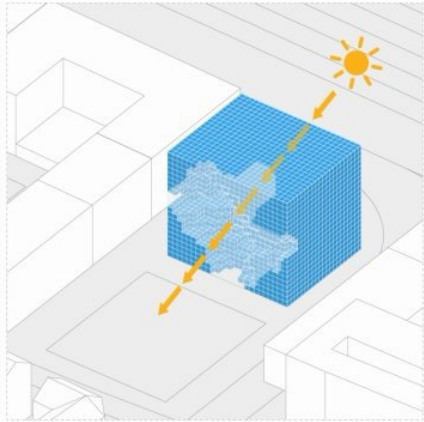

OPENING FOR SUNLIGHT

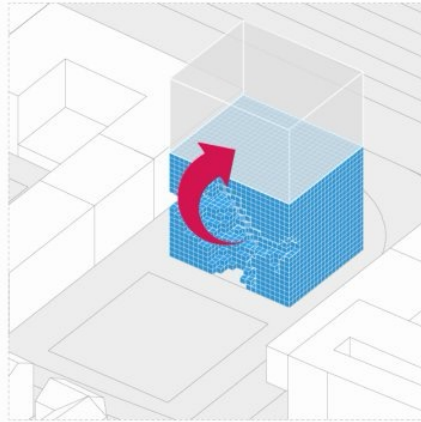

ADD PUSHED VOLUME ON TOP

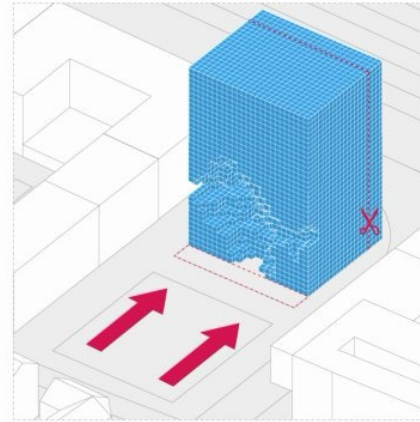

CUT

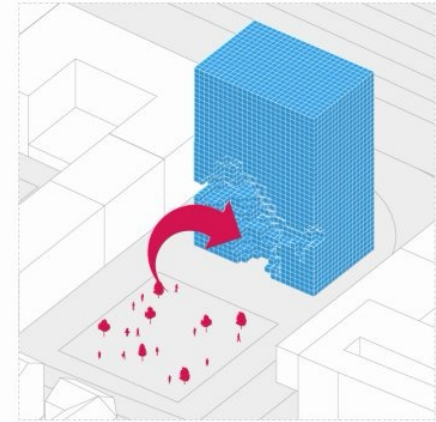

ACTIVATE

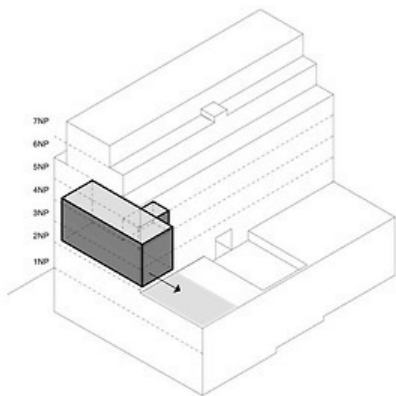

2–3NP
mezonet so súkromnou záhradou
144m²

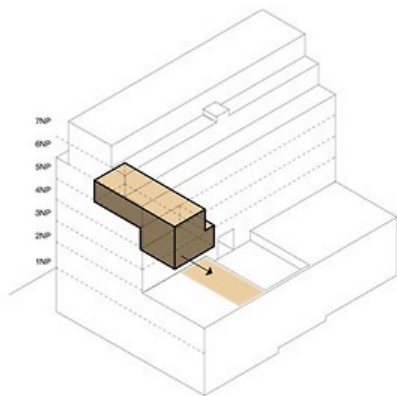

2–3NP
mezonet so súkromnou záhradou
102m²

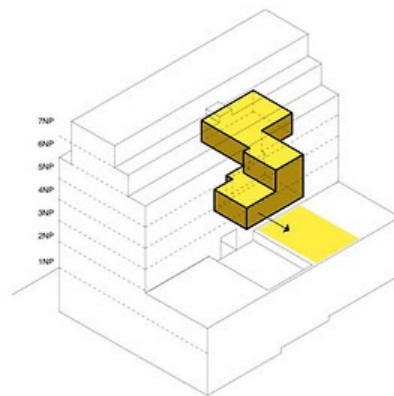

2–3NP
mezonet so súkromnou záhradou
138m²

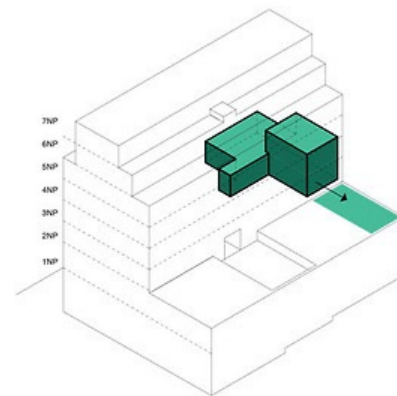

2–3NP
mezonet so súkromnou záhradou
129m²

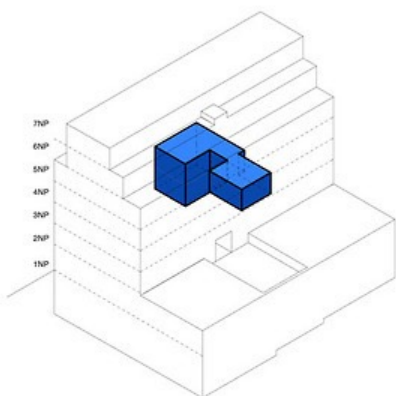

2–3NP
mezonet bez záhrady
101m²

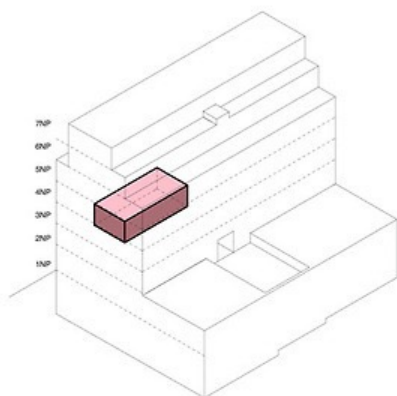

2NP
2i južný jednostranný byt
51m²

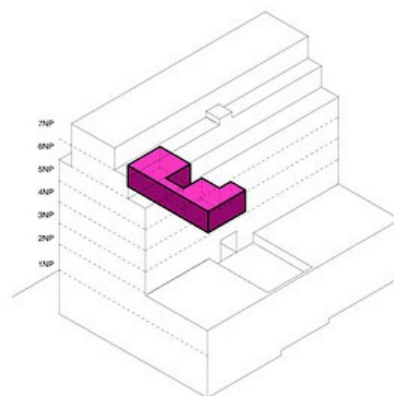

3NP
2i priečne prevetrávaný byt
57m²

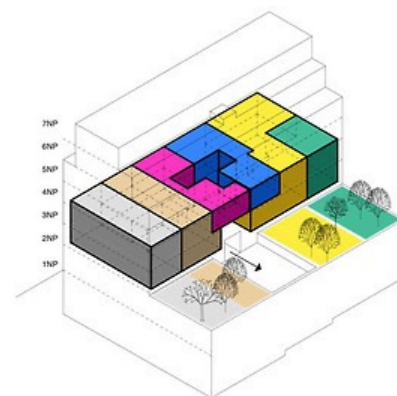

Priestorová organizácia bytov

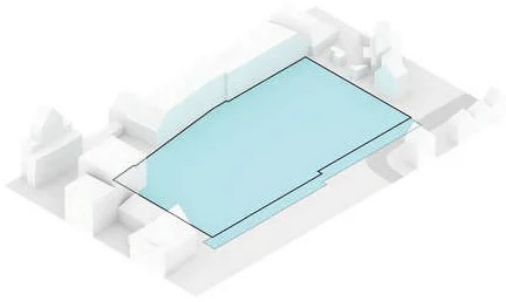

STEP 1: Create valley to lower roofline

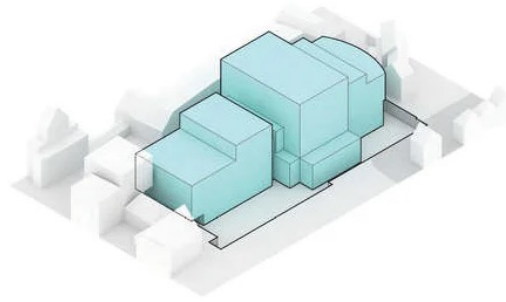

STEP 2: Add two stage back to back in valley

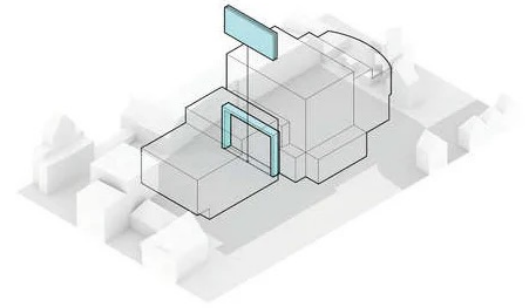

STEP 3: Create flexible stage connection

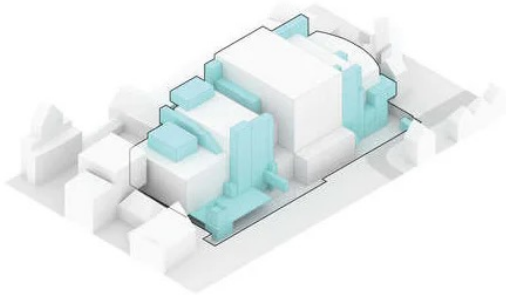

STEP 4: Add circulation and services



STEP 5: Wrap in artistic overlay

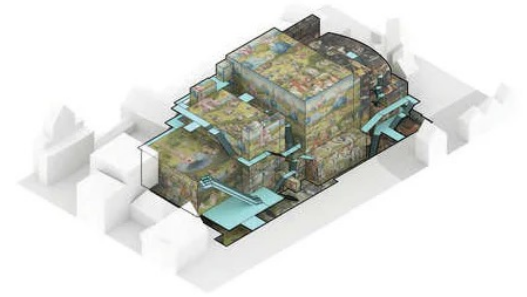

STEP 6: Add terraces and stairways

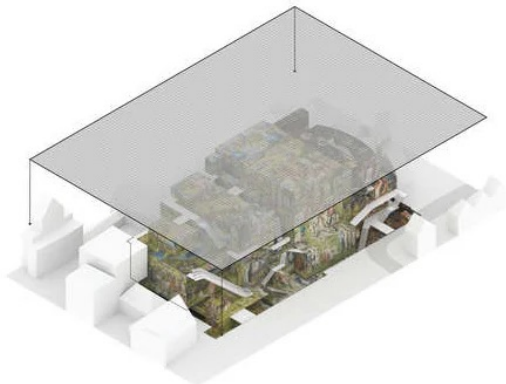

STEP 7: Drape with gridded facade

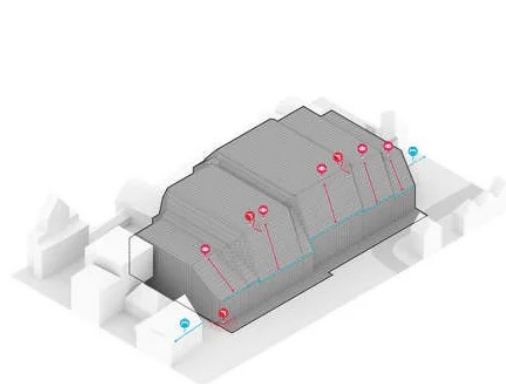

STEP 8: Chamfer to align with surrounding buildings

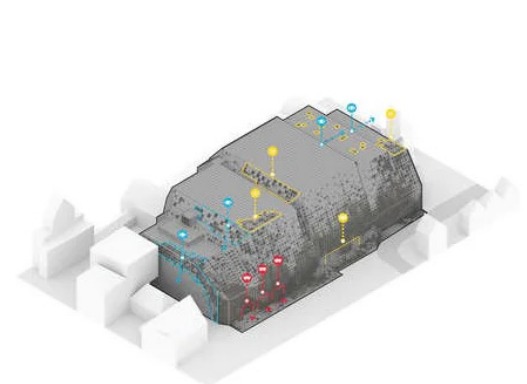

STEP 9: Add extra glazing where necessary

Form Finding

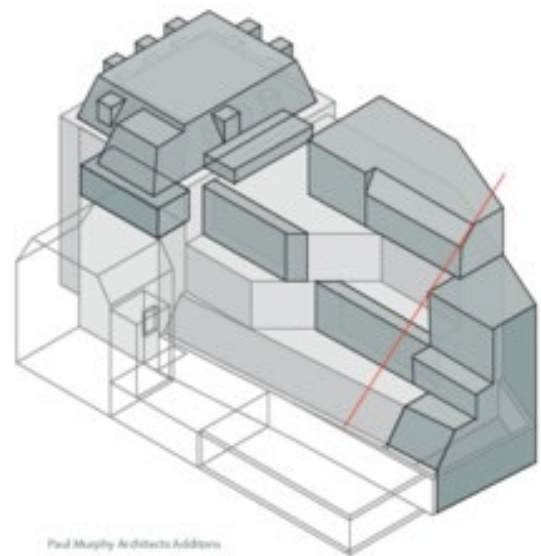
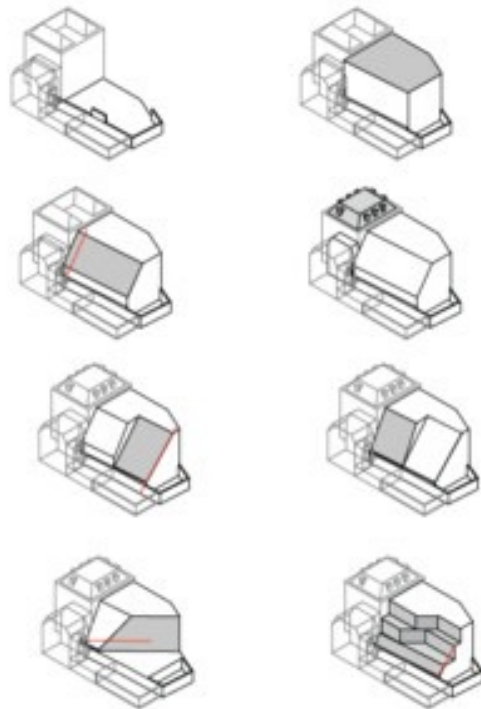

Paul Murphy Architects Additions

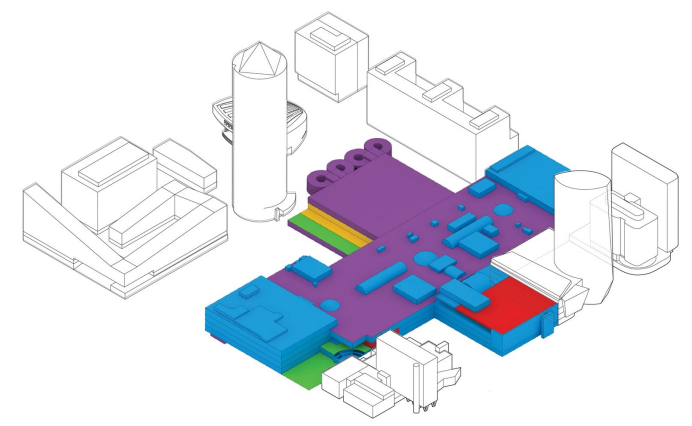
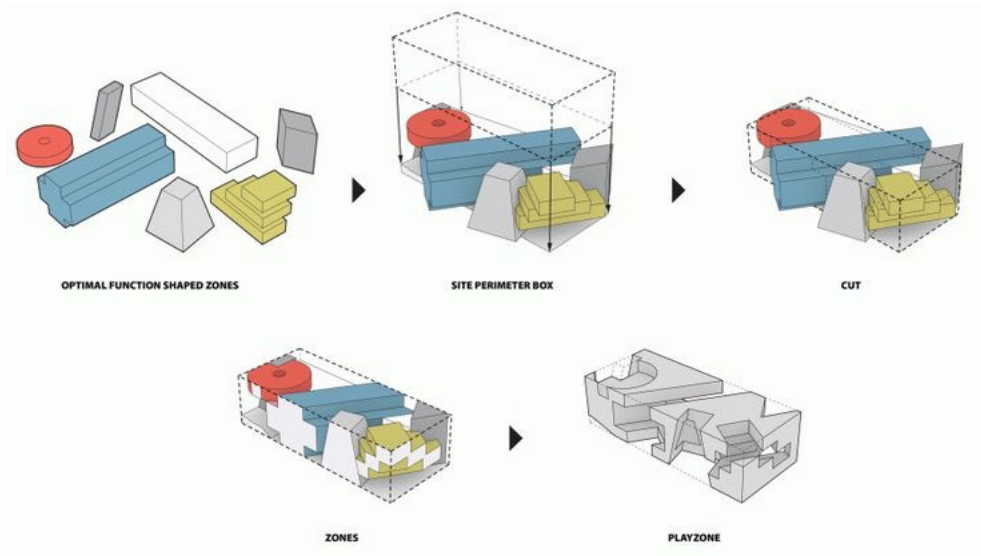

Existing programme

- Parking
- Shopping
- Greenery
- Food and beverage
- Leisure

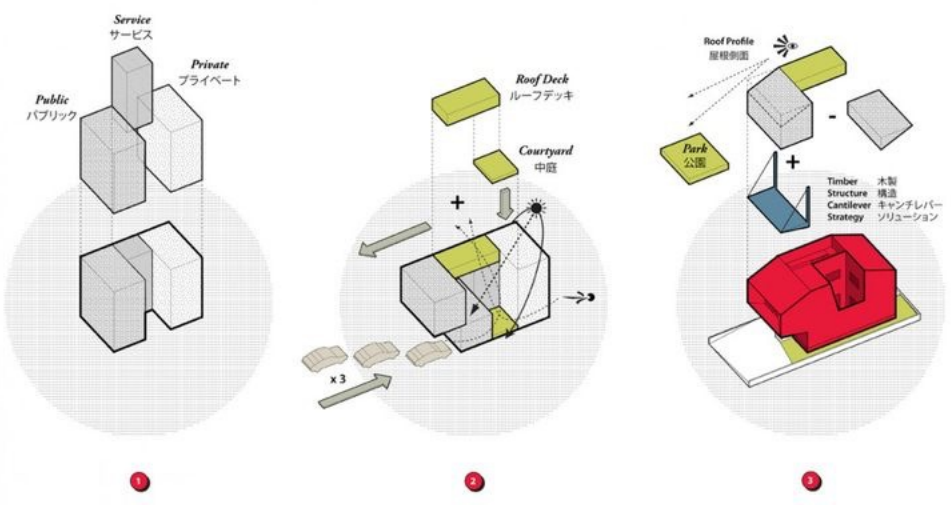

Intensification and diversification of uses

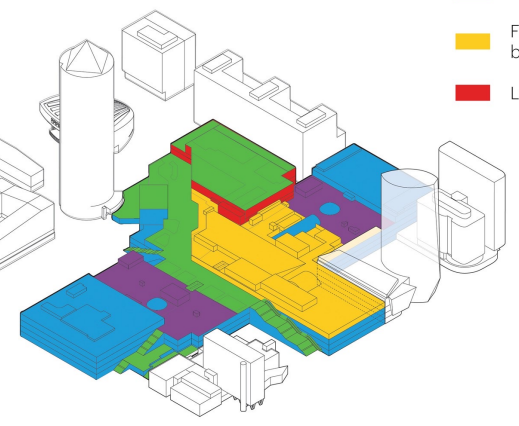

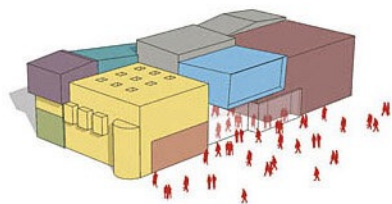
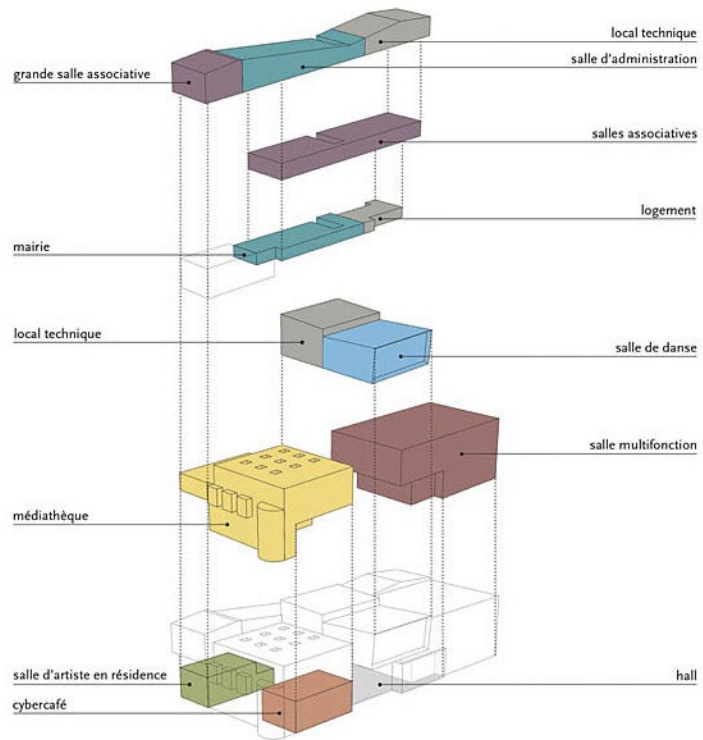

PROGRAM BARS

+

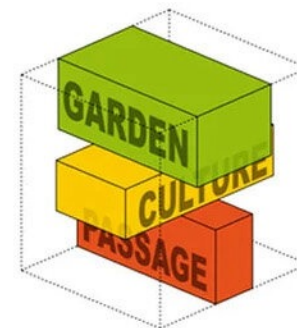

PROGRAM VOIDS

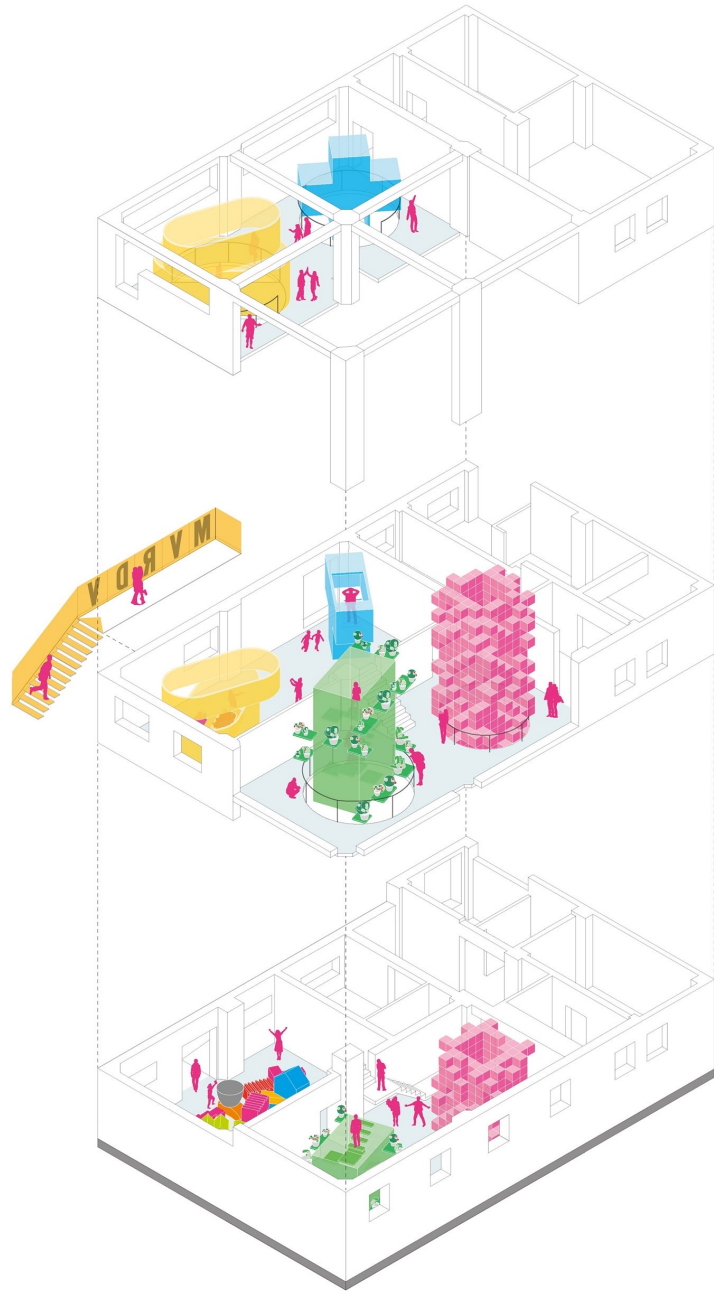



久染-



D1DEEA D2E4E3 D2E4E3 ADCEC6 9EAECC

小红书号: 503857189

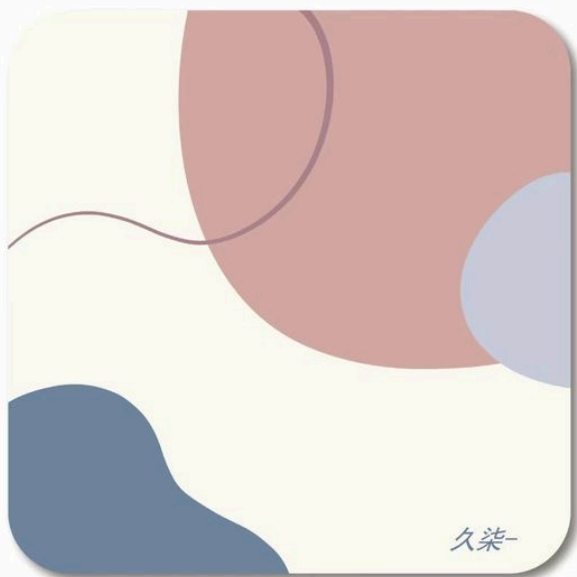

久染-



FEF9F3 C6CAD7 6B839C CFA5A2 A6C7C7

小红书号: 503857189



NEXTPURE



CFD9E5 B9C8DA E1C5CB BBD0B7 9CB297

小红书号: 503857189

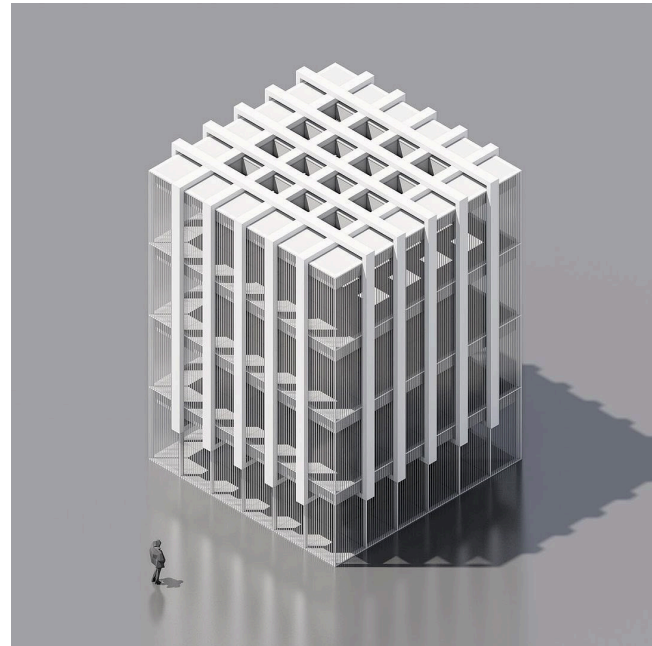
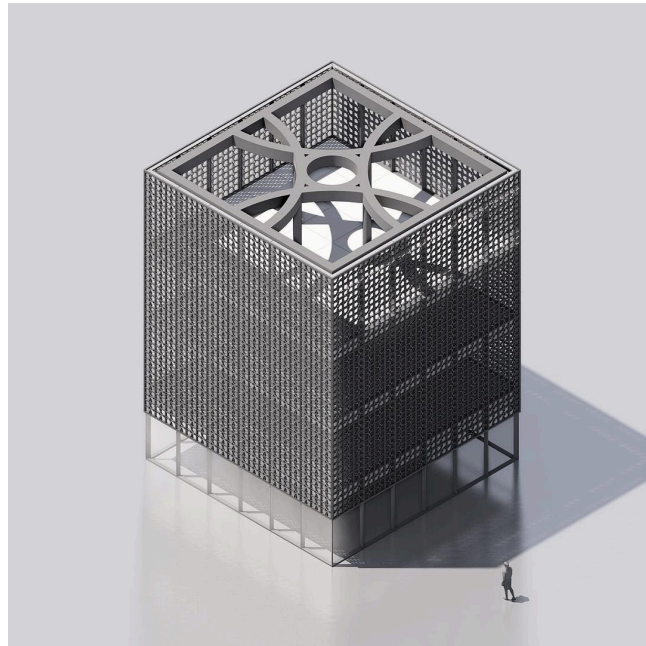
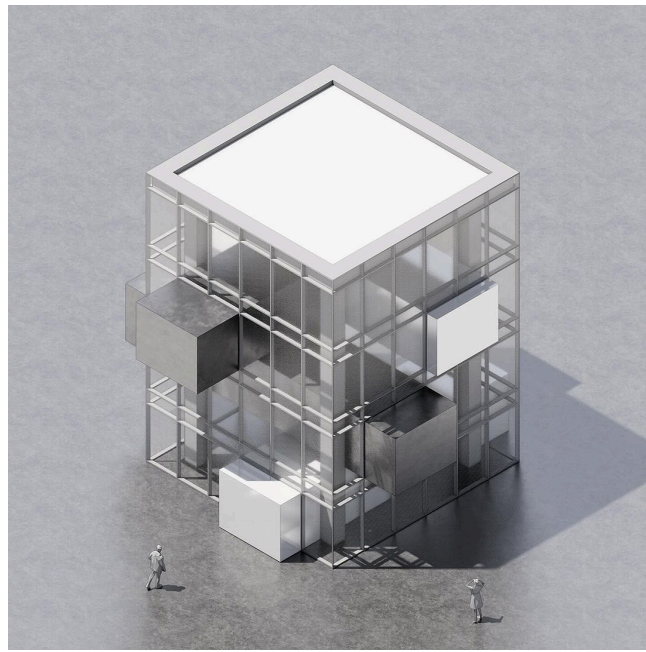
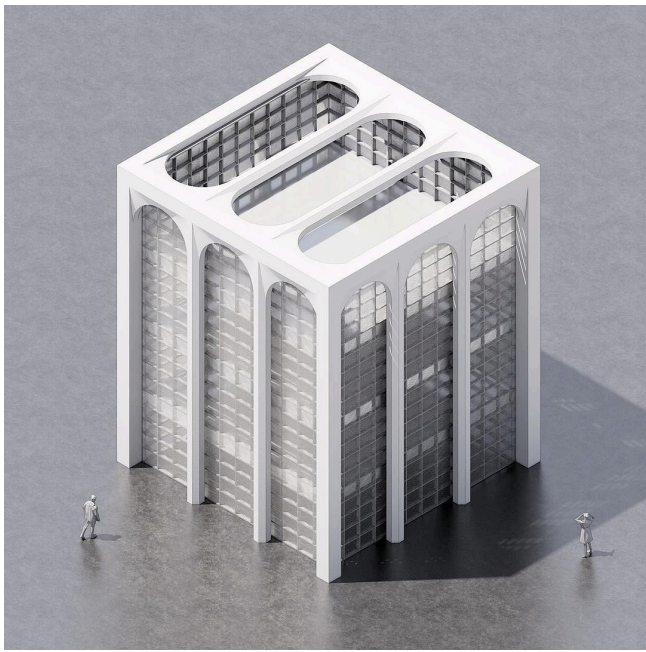



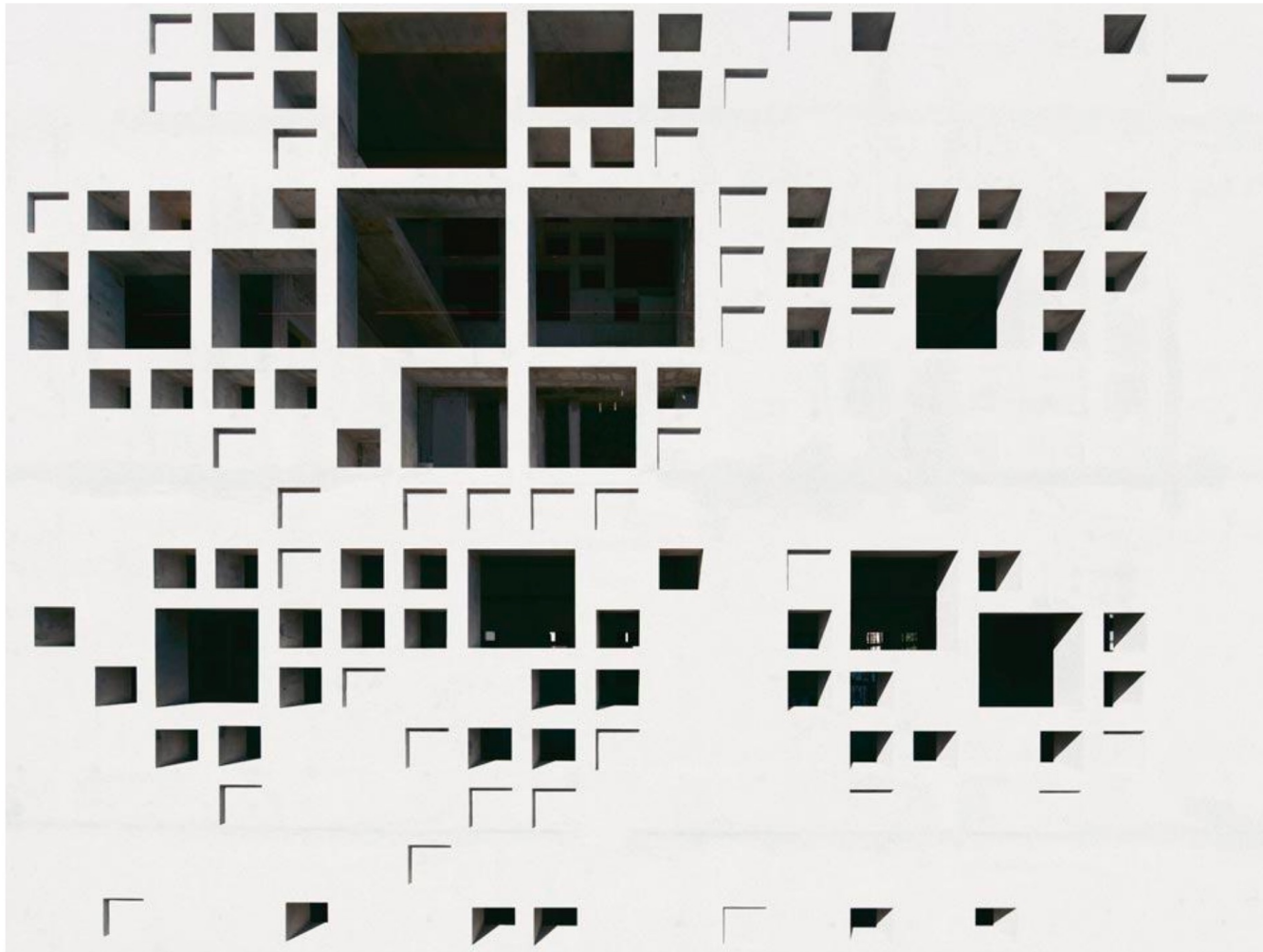

Nouvel
Tower
Λευκωσία





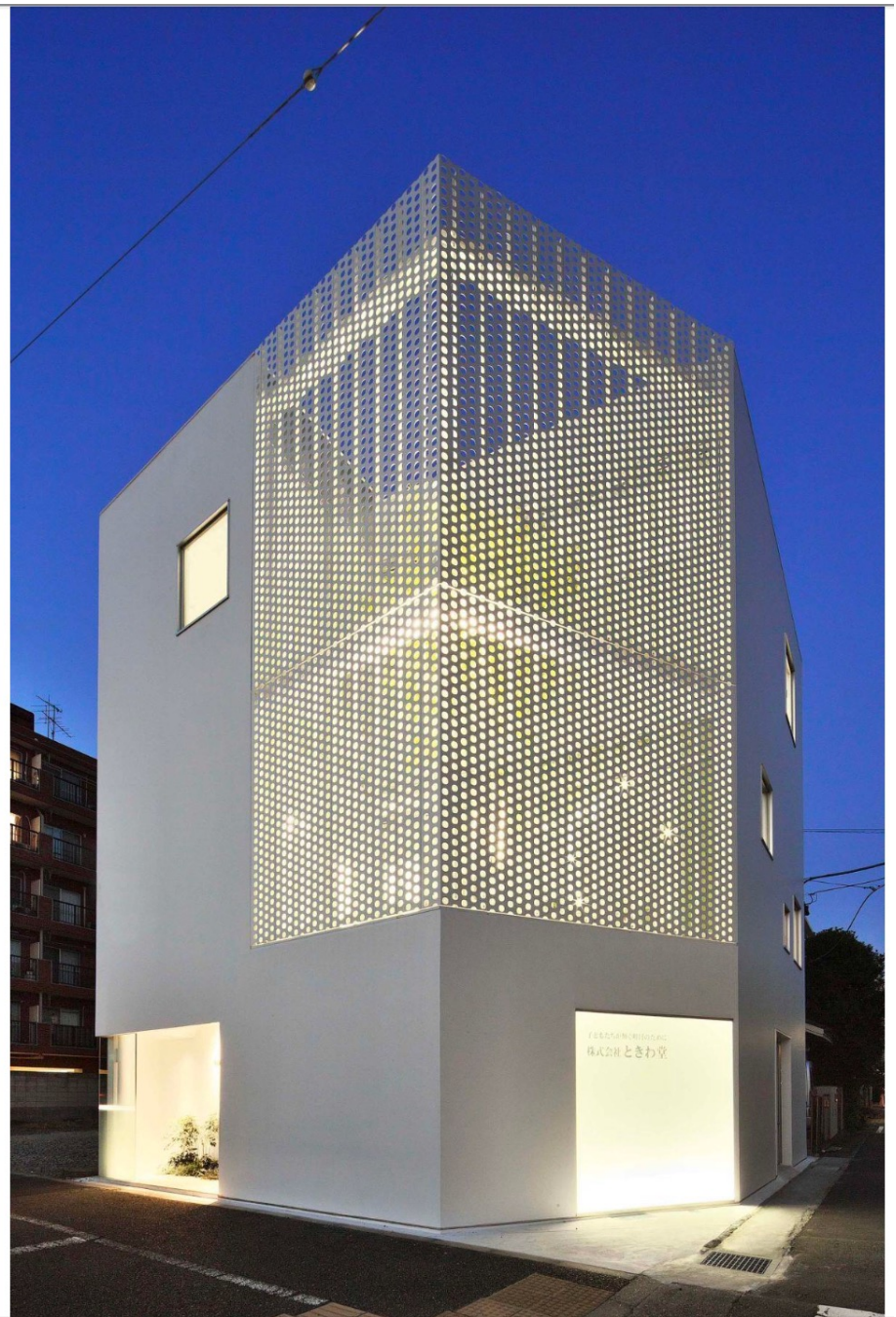







Rietveld Schroder
House



Κενά και πλήρη
ενσωματωμένα σε ένα
όγκο

Vila Savoy





Le Corbusier La Tourette (Yiannis Xenakis ο σχεδιασμός του υαλοστασίου)

Ο κάναβος

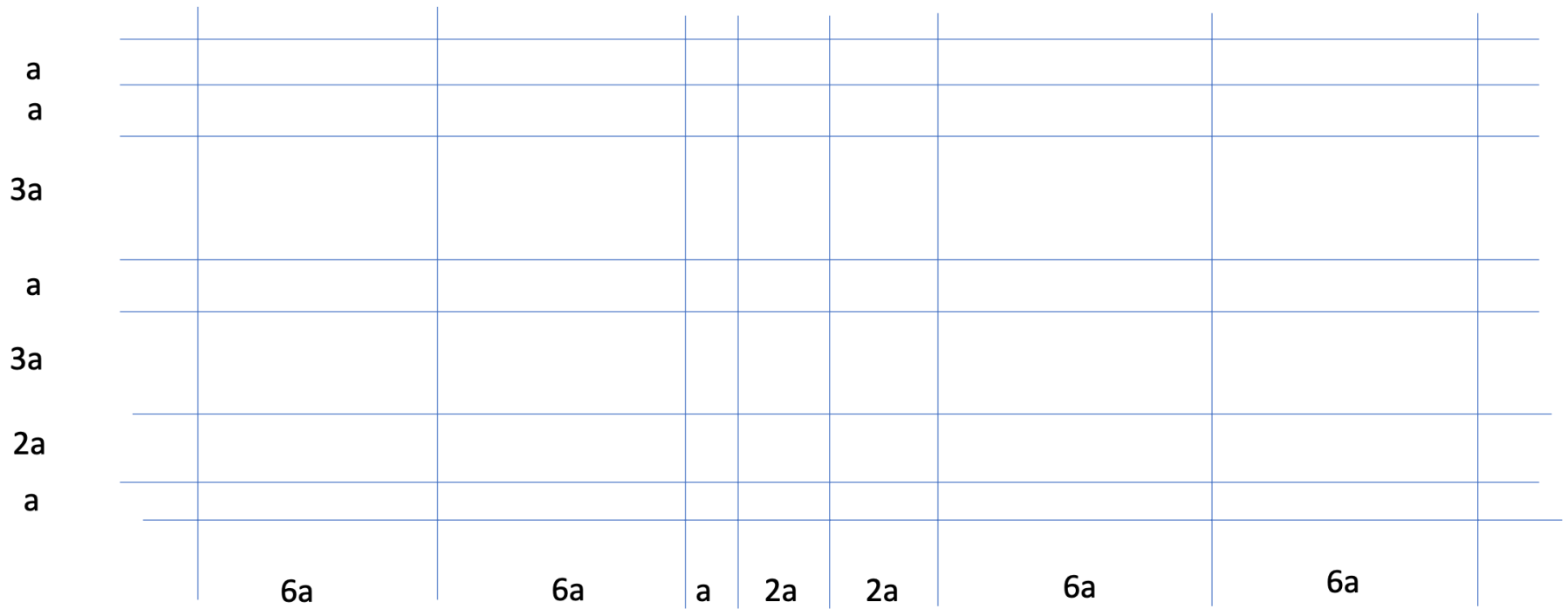

Ο κάναβος της τομής (πχ ανα 30 εκ)

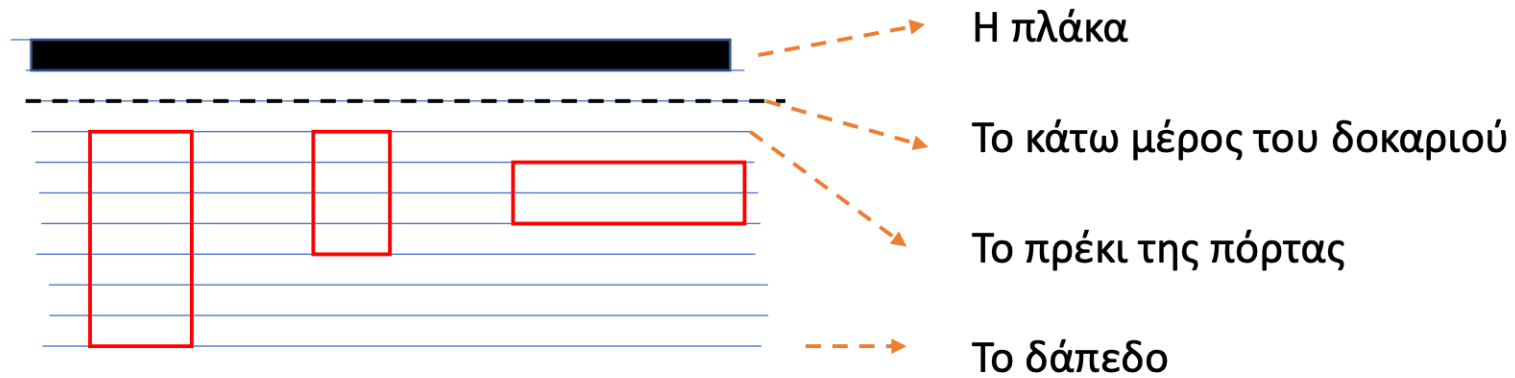

ΔΙΑΓΡΑΜΜΑ ΣΥΣΤΗΜΑΤΟΣ ΥΠΟΔΟΜΩΝ ΑΠΟΧΕΤΕΥΣΗΣ

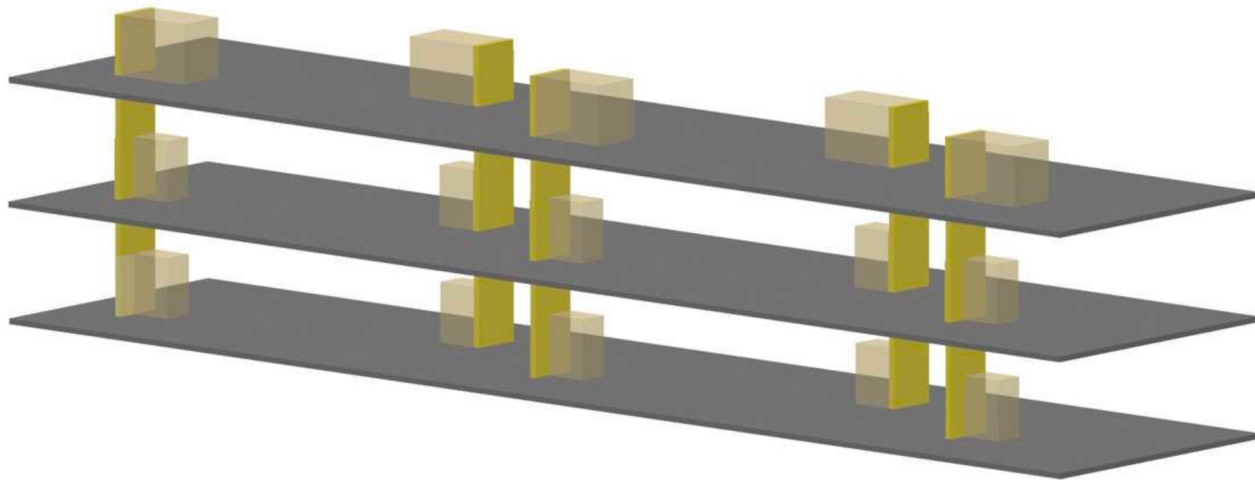

- ΚΑΤΑΚΟΡΥΦΟΣ ΚΟΙΝΟΣ ΤΟΙΧΟΣ ΠΟΥ ΕΜΠΕΡΙΕΧΕΙ ΤΙΣ ΣΩΛΗΝΟΣΕΙΣ
- ΛΟΥΤΡΑ ΚΑΙ W.C.

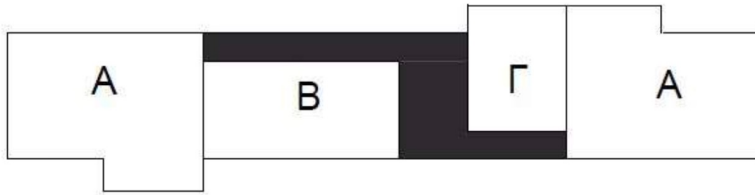

ΚΑΤΟΨΗ 1ου ΟΡΟΦΟΥ

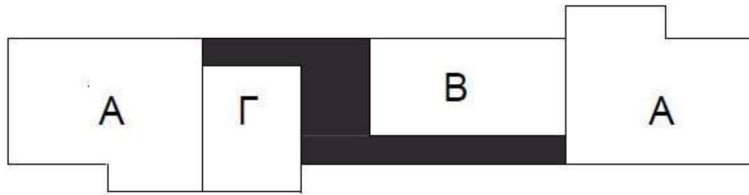

ΚΑΤΟΨΗ 2ου ΟΡΟΦΟΥ

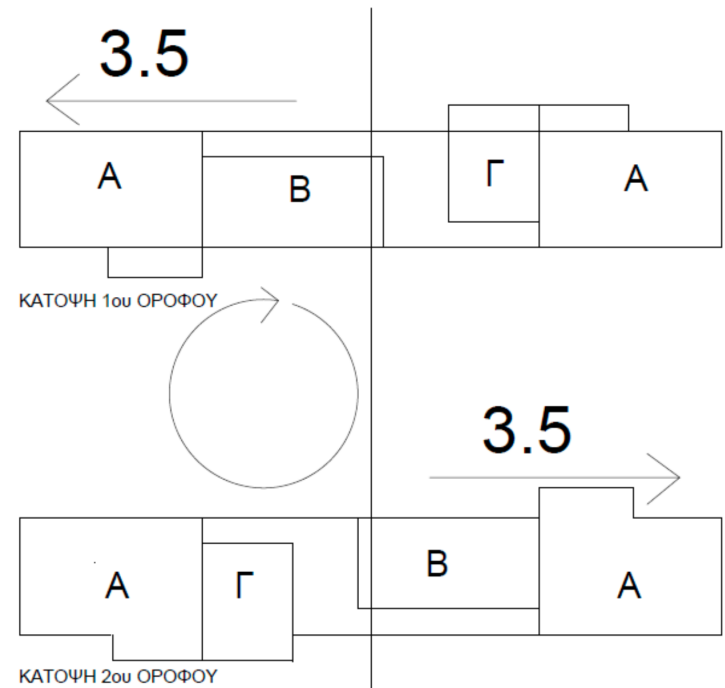









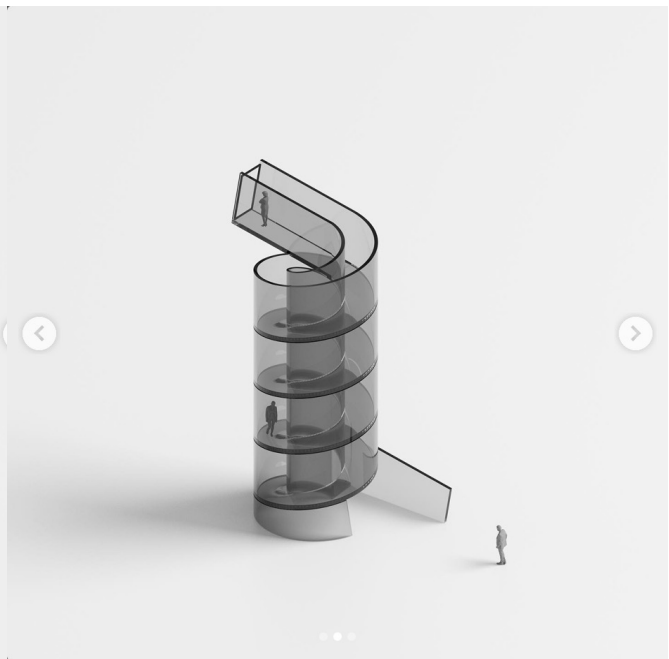
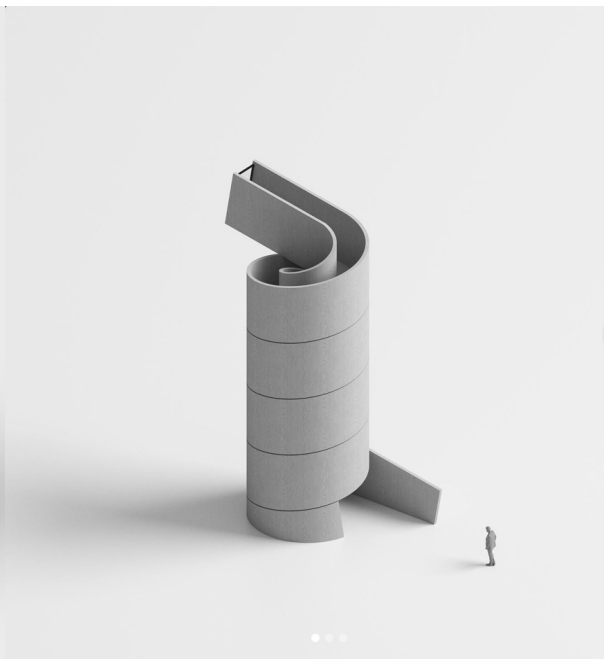

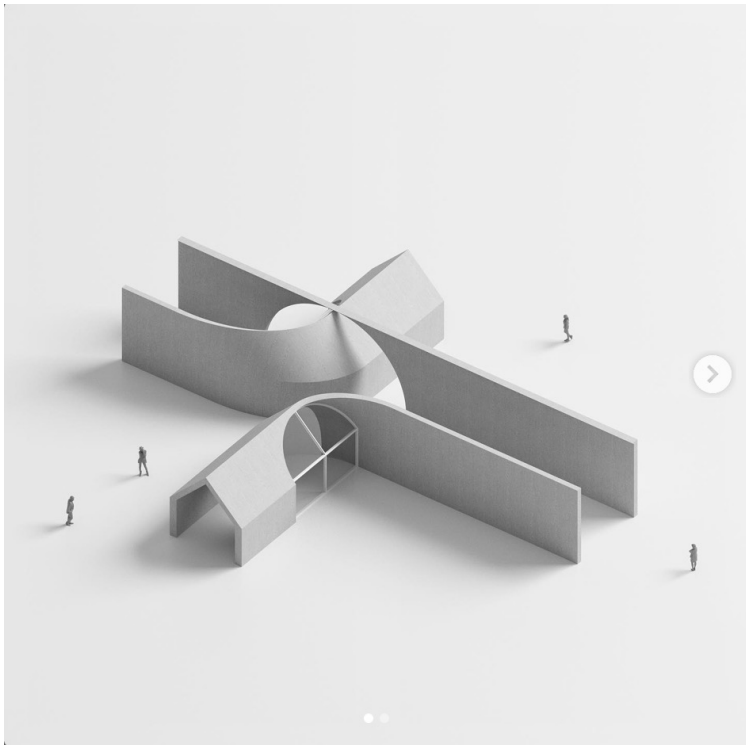





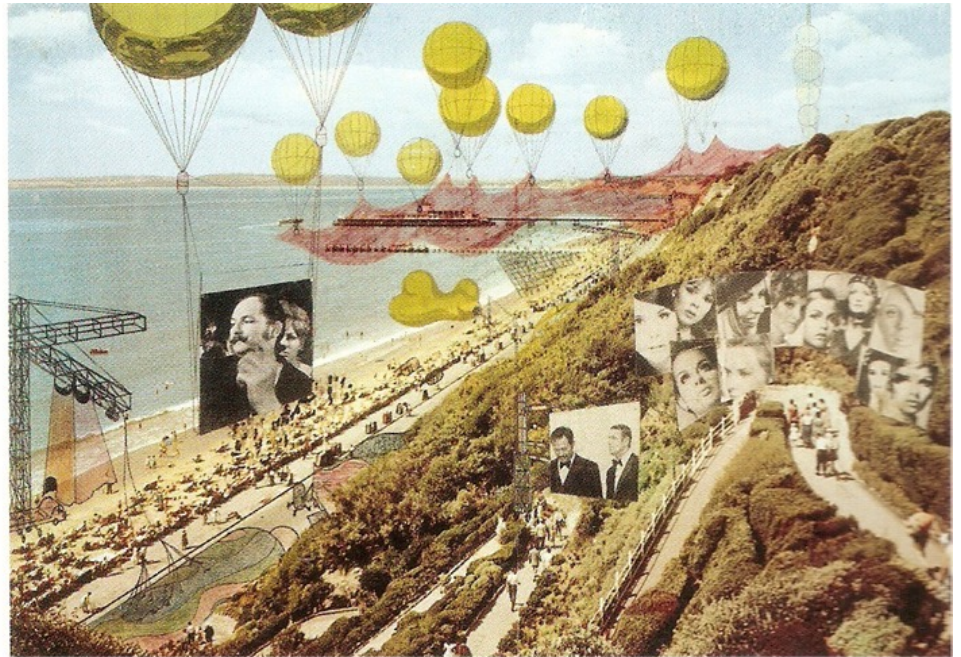
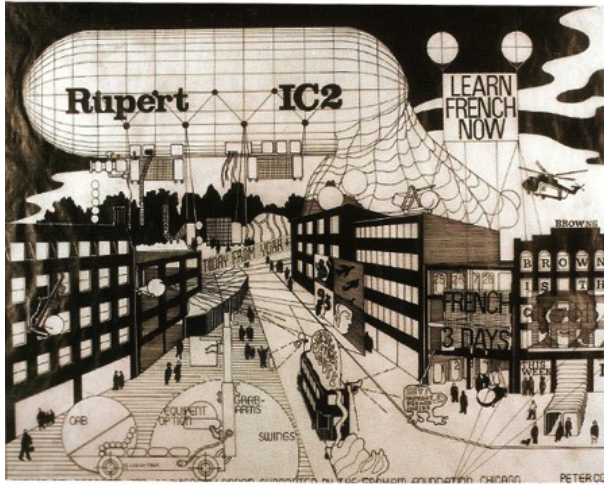

INSTANT CITY,
Archigram, Peter Cook & Ron
Herron, 1968-70

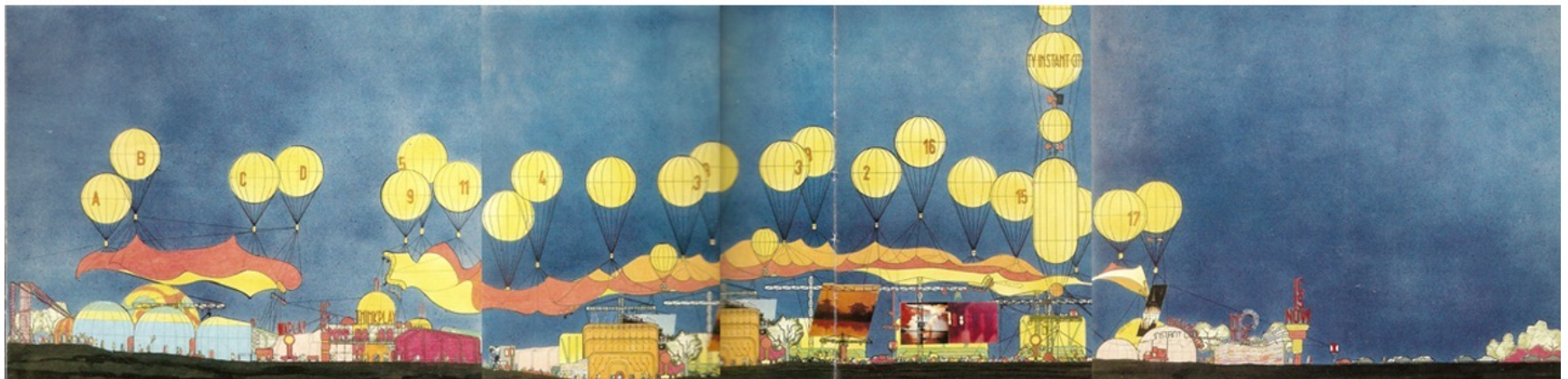

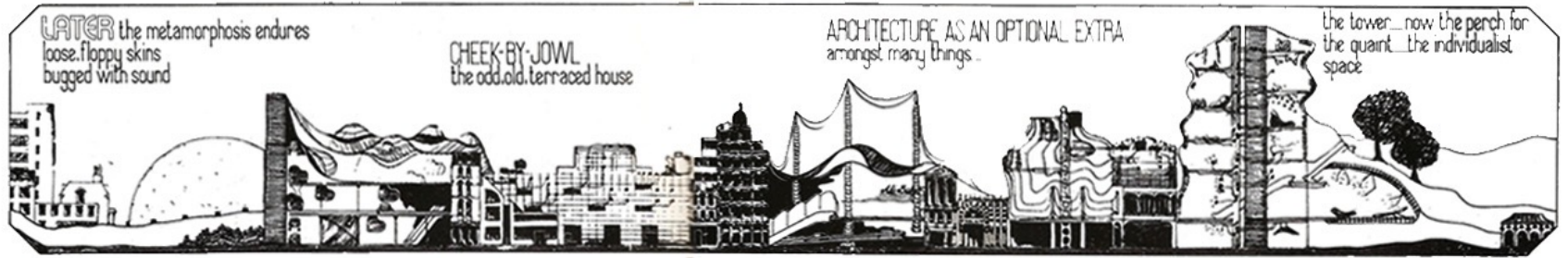

THE METAMORPHOSIS OF OUR TOWN IT HAPPENED CHEEK-BY-JOWL

THE METAMORPHOSIS OF AN
ENGLISH TOWN, 1970
Archigram



PlastiFab
Corporate
Illustration

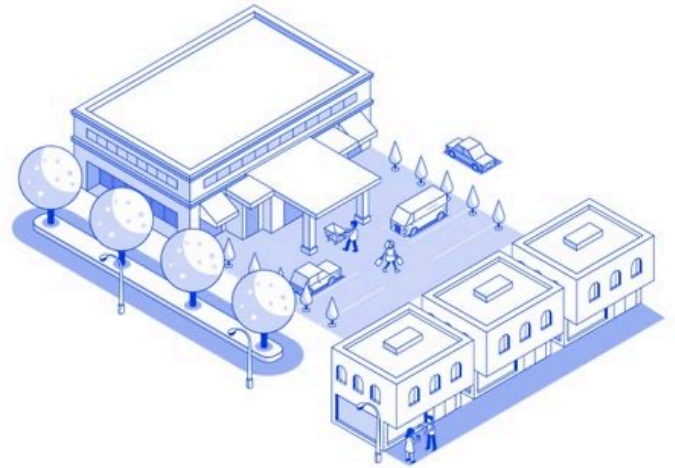

The Kraków Ghetto was formally established on 3 March 1941 in the historic Jewish district of Kazimierz. It was established for the purpose of extermination, terror, and persecution of local Polish Jews, as well as the staging area for separating the "able workers" from those who would later be deemed unworthy of life.



1942

The Plaszów camp was established in 1942 under the authority of the SS and police leaders in Kraków. It was initially a forced-labor camp for Jews. The original site of the camp included two Jewish cemeteries. From time to time the SS enlarged the camp.



1944

It reached its maximum size in 1944, the same year that it became a concentration camp. Plaszów was surrounded by an electrified barbed-wired fence and was divided into several sections. The camp had barracks for German personnel, gas factories, warehouses, a men's camp and a women's camp, and a "labor education camp" for Polish workers who resisted labor discipline. Poles and Jews were segregated within the camp. The largest number of people confined in Plaszów at any one time was over 28,000. Thousands were killed there, mostly by shooting.

1945

As the Soviet army approached in the summer of 1944, the Germans prepared to dismantle Plaszów. The SS transferred prisoners to other concentration camps in Germany and Austria. Others were deported to the Buchenwald-Birkenau killing center and murdered there. The Germans also attempted to remove all traces of the crimes that had been committed in the camp. They ordered that mass graves of Plaszów be opened and the bodies exhumed and burned. In January 1945, the last prisoners from Plaszów were sent to Buchenwald for execution further west.

1964

The area which held the camp now consists of sparsely wooded hills and fields, with one large memorial erected in 1964 to all the victims and two smaller monuments close to the Jewish cemetery generally, and another to the Hungarian-Jewish victims of one perimeter of where the camp was a field.



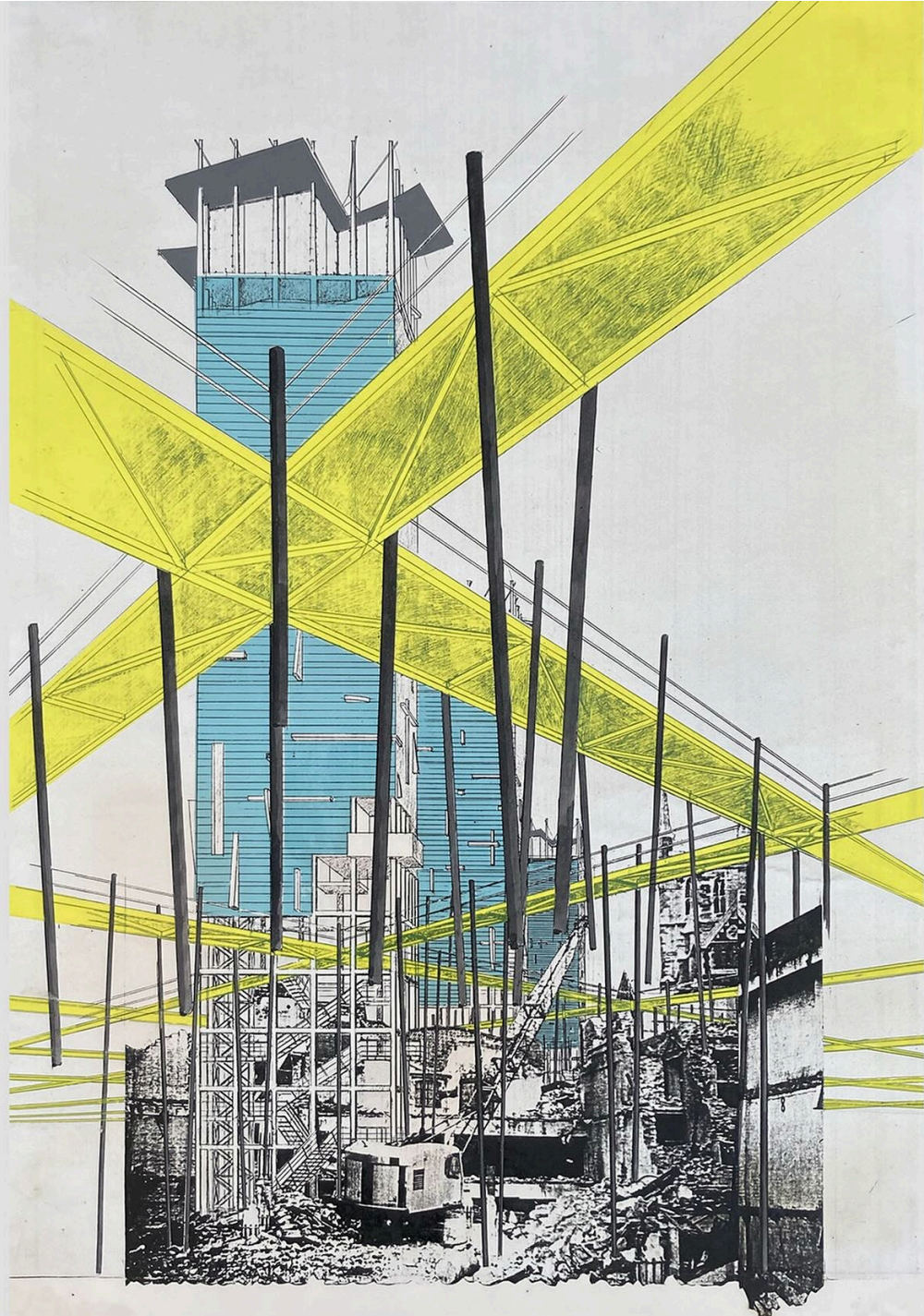



SITE MAP



CLIMATE GRAPHS



SCALE 1 : 100

SITE VIEW

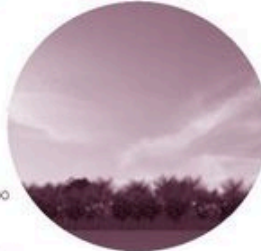

ISOMETRIC VIEW

SCALE 1 : 200

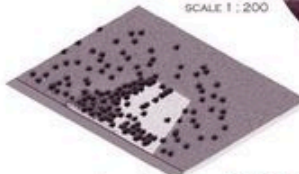

SITE PLAN

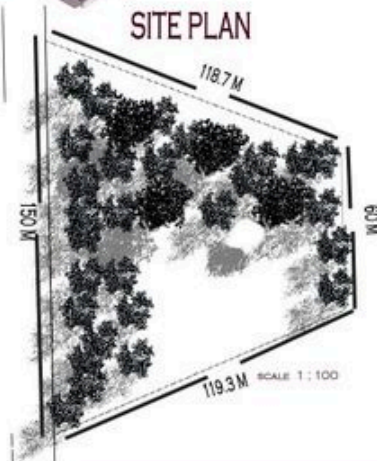

ACCESSIBILITY



INDIRA GANDHI INTERNATIONAL AIRPORT - 4 KM



NEW DELHI RAILWAY STATION - 4.2 KM



KENDRIYA TERMINAL - 3 KM

STRENGTH

THE SITE IS LOCATED IN AREA OF NATIONAL IMPORTANCE, SURROUNDED BY HISTORICALLY IMPORTANT ARCHITECTURE. SITE IS GEOGRAPHICALLY PLAIN. SITE IS EASILY ACCESSIBLE AND IT LIES PERPENDICULAR TO RAJPATH.

OPPORTUNITIES

THE DESIGN MAY REACH TO HIGHER IMPORTANCE AS IT IS LOCATED ADJACENT TO TWO IMPORTANT MEMORIALS. THE SITE WILL ALWAYS BE MAINTAINED WELL DUE TO ITS IMPORTANCE.



WEAKNESS

VIEWS INTO AND OUT TO THE SITE IS BLOCKED BY TREES AND OTHER VEGETATION. SITE LOCATION IS SENSITIVE AS IT MARKS THE PRESENCE OF HISTORICALLY IMPORTANT INDIA GATE, WAR MEMORIAL ETC., SO HAS TO BE DESIGNED CAREFULLY.

THREATS

THE NEIGHBOURING AREA IS EMBEDDED WITH TOO MANY ART GALLERIES AND MEMORIALS, THIS CAN ATTRACT ONLY A SPECIFIC INTEREST GROUP.

SITE SECTION



SCALE 1 : 100

HIBA ABOOBACKER
S5 BARCH

SITE CONTEXT

